

- NOTES:
- GEOGRID REINFORCEMENT MATERIAL AND EMBEDMENT LENGTH TO BE ESTABLISHED BY PROFESSIONAL ENGINEER REGISTERED IN THE STATE OF SOUTH CAROLINA BASED UPON CURRENT AND PROJECTED LOADINGS AND PROPER DRAINAGE. MINIMUM GEOGRID LENGTH TO BE 0.75 TIMES THE MAXIMUM WALL HEIGHT AND TO BE UNIFORM FOR ALL LAYERS. SEE SPECIFICATION SECTION 13800 FOR GEOGRID REQUIREMENTS.
 - PROVIDE POSITIVE DRAINAGE AWAY FROM BACK OF WALL.

D
1 MSE WALL SECTION

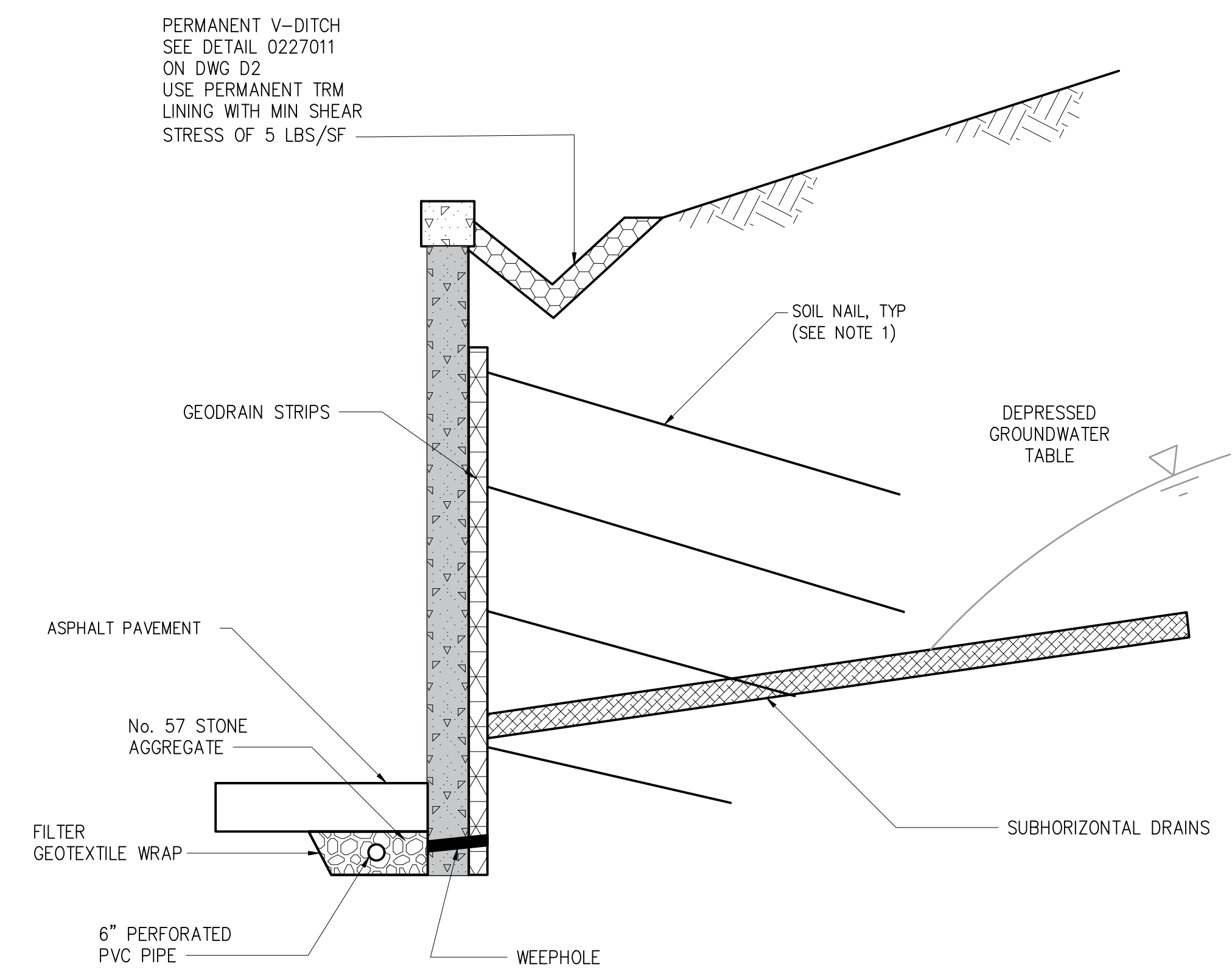

- NOTES:
- SOIL NAIL SPACING AND DEPTH DESIGN TO BE DETERMINED BY SOIL WALL INSTALLER.

D
2 PERMANENT SOIL WALL

File: 032305-018-DRAWING.DWG
 Plot Date: 1/16/2019 1:48 PM
 By: SMASH

PROJECT ENGINEER:	M. BRIDWELL
DESIGNED BY:	S. NASH
DRAWN BY:	S. NASH
CHECKED BY:	M. SANTOWASSO
ADDENDUM No. 2	1/2019 MWB
CONSTRUCTION	12/2018 MWB
REGULATORY APPROVAL	8/2018 MWB
ISSUED FOR	DATE BY

ISSUED FOR CONSTRUCTION

Hazen
 HAZEN AND SAWYER
 9101 SOUTHERN PINE BLVD, SUITE 250
 CHARLOTTE, NC 28273
 LICENSE NO.: C-0381

RENEWABLE WATER RESOURCES
 GREENVILLE, SOUTH CAROLINA

 LOWER REEDY WRRF
 DIGESTER CAPACITY IMPROVEMENTS

CIVIL
 RETAINING WALL DETAILS

DATE:	DECEMBER 2018
HAZEN NO.:	32305-018
CONTRACT NO.:	01
DRAWING NUMBER:	C15